

Spot micro D

REF : SD000

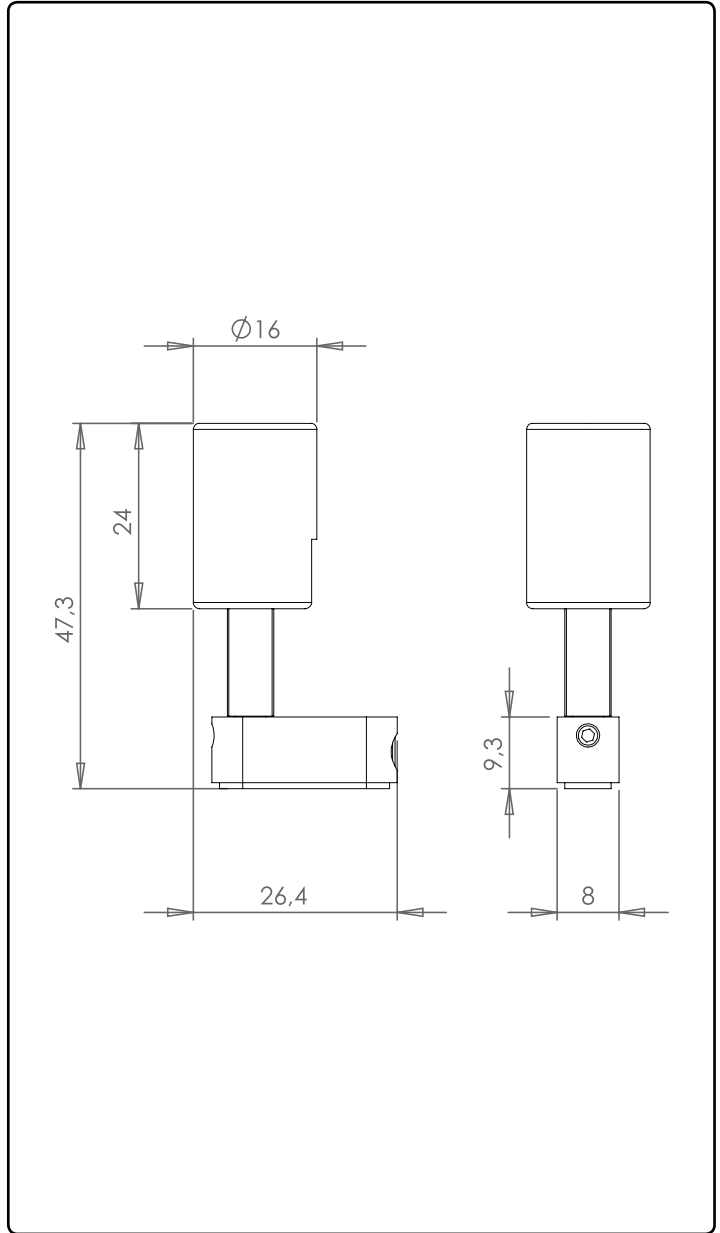

↓ PRODUCT DESCRIPTION

This high-efficiency articulated microspot, part of the D range offers a high degree of lighting efficiency despite its small size. Used for precision luminous flux, its sleek, miniaturized design makes it very easy to fit in shop windows, display units, and other small spaces.

↓ OUTPUT (PEG)

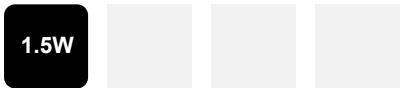

↓ OUTPUT (TRACK, RCA)



↓ CRI



↓ USE



↓ IP



↓ POWER SUPPLY (PEG)

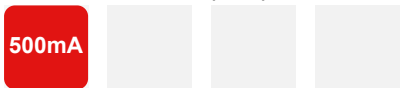

↓ LUMENS



↓ ADJUSTABLE DEGREES



↓ POWER SUPPLY (TRACK, RCA)



↓ DIMMING



↓ COLOUR TEMPERATURE



↓ STANDARDS COMPLIANCE



↓ COLOURS



↓ SOURCES

- Luminous flux according to Bining: 150 lumens
- Colour temperature : de 2400K to 5000K
- Service Range: 70 % of nominal flux after 50 000 hours
- Colour Rendering Index: CRI 90

↓ OPTICAL

- PMMA acrylic lens, efficiency ~90%
- Available degrees : 16°, 24°, 40° et Elliptic

↓ ELECTRICAL (on peg)

- Power supply 500mA
- Reversible polarity and hot plug
- Power consumption to 1.5W max, excluding supply
- Electrical Classification : Class III SELV device

↓ ELECTRICAL (on tracks or RCA)

- Power supply 24V
- Electric transmission by magnetic contact
- Reversible polarity and hot plug
- Power consumption to 2W max, excluding supply
- Electrical Classification : Class III SELV device

↓ MECHANICAL

- Electronic circuit encased in a fire-proof polycarbonate housin
- Fixing by magnetic contact (on track)
- Operating temperature : -5° +40°
- Articulating base
- ROHS components
- Interior use only

↓ SPECIFICITIES

- 3 years guarantee

↓ NOMENCLATURE

Product Ref.	SD000		
Specification	Simple peg	A	
	RCA	ARCA	
	Piccolo track	P	
	Slim track magnet	SMA	
Degrees	16°		16
	24°		24
	40°		40
	Elliptic		ELL
Colour	Black		BK
	White		WH
	Custom		CU
Temperature	2400K		24
	2700K		27
	3000K		30
	3500K		35
	4000K		40
	5000K		50
REFERENCE	SD000	P	40 BK 27

BEAM ANGLE

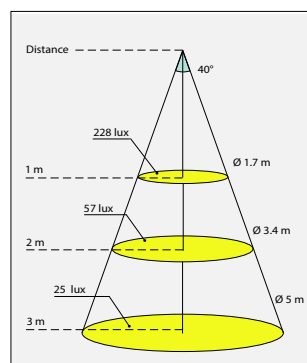
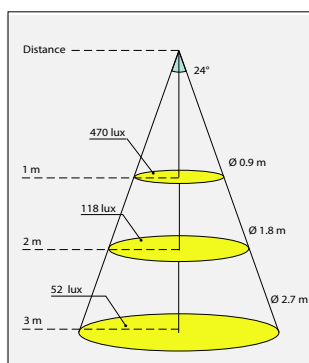
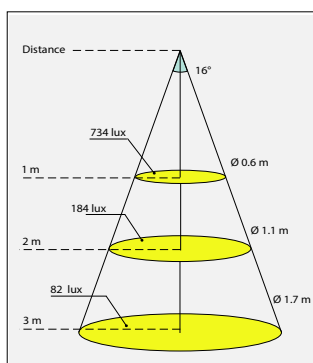

Spot micro D

MOUNTING CONFIG.

REF : SD000

SPOT EN

↓ MOUNTING CONFIGURATION

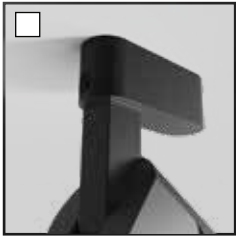

SD000A
Fixing mounting simple
(except BA13)



SD000SMA
Slim track Width 13mm



SD000P
Piccolo track Width 27mm



SD000ARCA
RCA

**RCA ACCESSORY
NEXT PAGE**

ACCESSORY (OPTIONAL)
TO BE ADDED TO THE
«FIXING MOUNTING SIMPLE»



ACSFIPATER43XXENCC
Fixing mounting recessed
(driver out)
Ø43mm H34mm



ACSFIPATER60XXENCC
Fixing mounting recessed
(driver in)
Ø60mm H34mm



ACSFIPATER43XXAPPC
Fixing mounting ceiling
(driver out)
Ø43mm H30mm



ACSFIPATER70XXAPPC
Fixing mounting ceiling
(driver in)
Ø70mm H42.5mm

↓ EXAMPLE OF CONFIGURATION

SPOT D - FIXING MOUNTING SIMPLE + FIXING MOUNTING RECESSED Ø60 - **NOIR**
= SD001A-ACSFIPATER60**BK**ENCC

Spot micro D

RCA ACCESSORIES

REF : SD000

SPOT EN

↓ MOUNTING RCA TRIMLESS SPOT

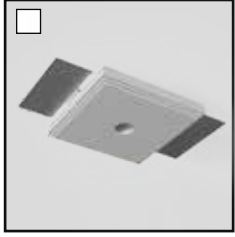

ACSD-RCA-PLA-13
RCA recessed trimless plug
Plaster 13mm

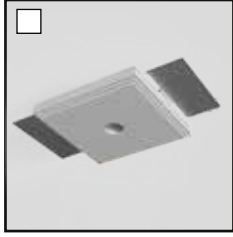

ACSD-RCA-PLA-18
RCA recessed trimless plug
Plaster 18mm

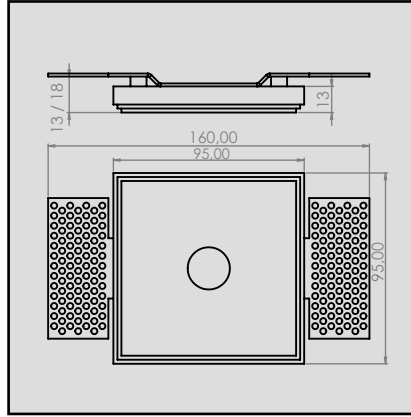

IN SITUATION



ACCOVERRCA TLXXC
RCA cover trimless

↓ MOUNTING RCA TRIM SPOT



ACSD-RCA
RCA peg female (trim)

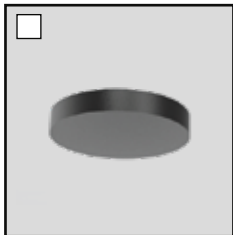

ACSD-RCA-CO
RCA cover trim

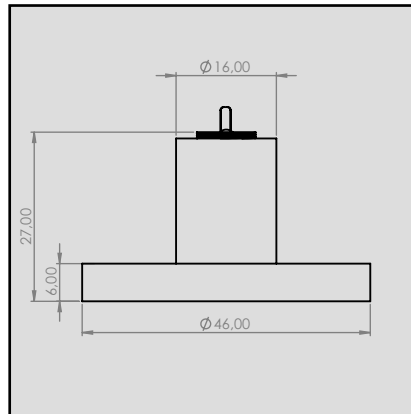

IN SITUATION

Spot micro D

ACCESSORIES

REF : SD000

SPOT EN

↓ CONNECTORS INDEPENDENT CONNECTION TO BATTERIES

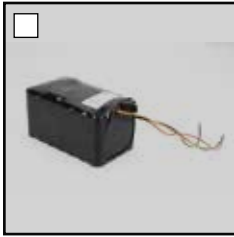

ACSD000COPLITHXX010
Pack Lithium 10,4Ah



ACSD000COCLITHXX35
Charger Pack Lithium
Charger 29,4V 3,5A

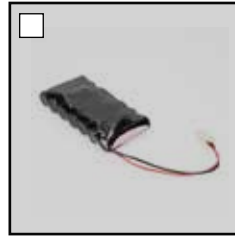

ACSD000COPLITHXX26
Pack Lithium 2,6Ah



ACSD000COCLITHXX06
Charger Pack Lithium
Charger 29,4V 0,6A

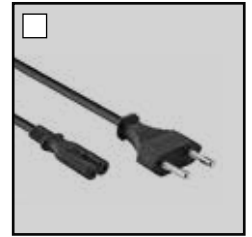

EUROPLUG

POWER SUPPLY CONNECTORS



ACSD000COCIRCPXX500
Piccolo circuit with sheath
heat-shrinkable

↓ OPTICAL ACCESSORIES

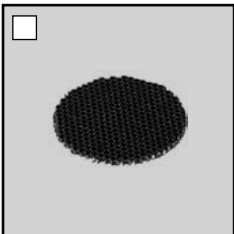

ACMMC01OPNIDABBKD14C
Honey comb D14mm