

Spot mini D

REF : SD002

SPOT EN

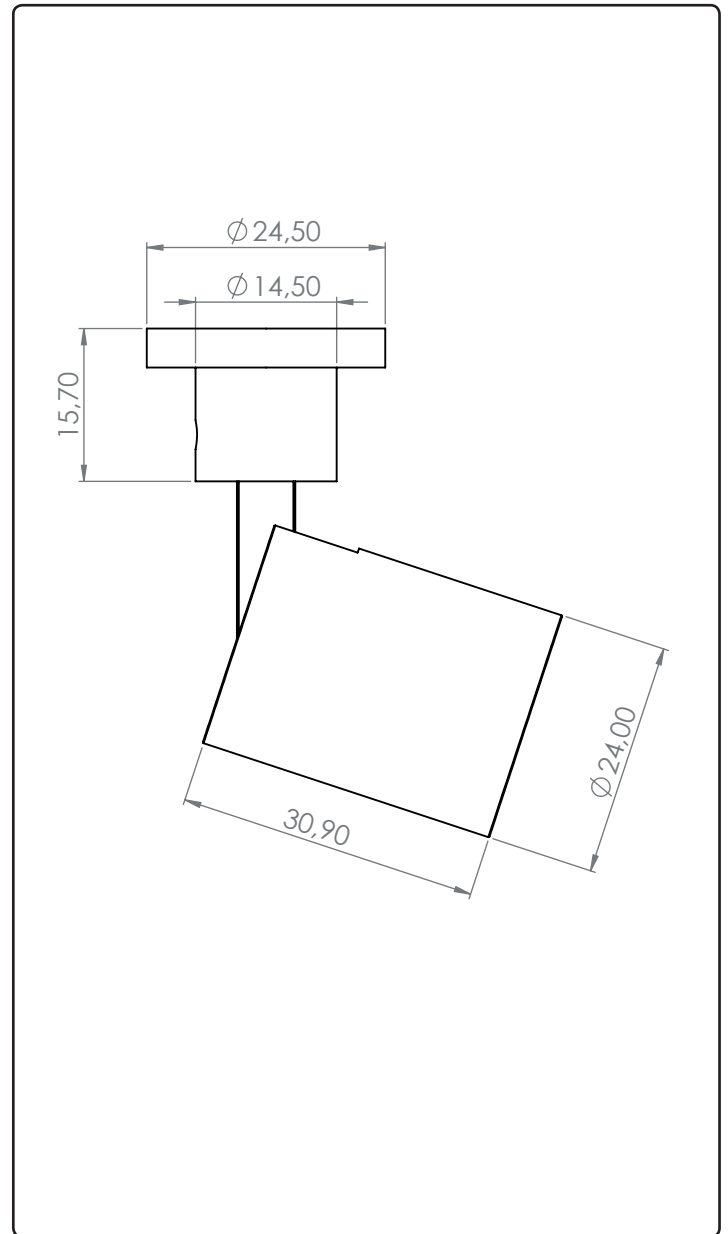

↓ PRODUCT DESCRIPTION

Particularly appreciated in commercial architecture and scenography for its precision lighting, this mini spotlight, featuring the distinctive articulation of the D range, stands out for its high luminous efficiency and compact size. Its discreet and elegant design offers a wide selection of optical characteristics, color temperatures, and finishes, providing numerous customization options.

↓ OUTPUT (PEG)



↓ OUTPUT (TRACK, RCA)

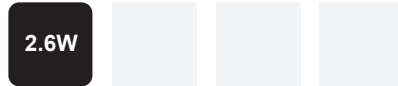

↓ CRI



↓ USE



↓ IP



↓ POWER SUPPLY (PEG)

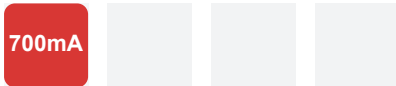

↓ LUMENS



↓ DEGREES



↓ POWER SUPPLY (TRACK, RCA)



↓ DIMMING



↓ COLOUR TEMPERATURE



↓ STANDARDS COMPLIANCE



↓ COLOURS



↓ SOURCES

- Luminous flux according to Bining: 200lumens
- Colour temperature : de 2400K to 5000K
- Service Range: 70 % of nominal flux after 50 000 hours
- Colour Rendering Index: CRI 90

↓ OPTICAL

- PMMA acrylic lens, efficiency ~90%
- Degrees : 10°, 29°, 48° and Elliptic

↓ ELECTRICAL (on peg)

- Power supply 700mA
- Reversible polarity and hot plug
- Power consumption to 2.1W max, excluding supply
- Electrical Classification : Class III SELV device

↓ ELECTRICAL (on tracks or RCA)

- Power supply 24V
- Electric transmission by magnetic contact
- Reversible polarity and hot plug
- Power consumption to 2.6W max, excluding supply
- Electrical Classification : Class III SELV device

↓ MECHANICAL

- Electronic circuit encased in a fire-proof polycarbonate housin
- Fixing by magnetic contact (on track)
- Operating temperature : -5° +40°
- Articulating base
- ROHS components
- Interior use only

↓ SPECIFICITIES

- 3 years guarantee

↓ SPOT NOMENCLATURE

Product Ref.	SD002		
Product specification	Simple peg	A	
	RCA	ARCA	
	Piccolo track	P	
	Slim track magnet	SMA	
Colour	Black	BK	
	White	WH	
	Custom	CU	
Temperature	2400K		24
	2700K		27
	3000K		30
	3500K		35
	4000K		40
	5000K		50
Degrees	16°		10
	24°		29
	40°		48
	Elliptic		ELL
REFERENCE	SD002	A	BK 24 10

↓ MOUNTING NOMENCLATURE

Mounting spec.	Mounting recessed Ø43	ACSFIPATER43	ENCC
	Mounting recessed Ø60	ACSFIPATER60	ENCAC
	Mounting ceiling Ø50	ACSFIPATER50	APPC
	Mounting ceiling X1spot	ACSFIPA1704030	AP1C
	Mounting ceiling X2spot	ACSFIPA1704030	AP2C
Colour	Black		BK
	White		WH
	Custom		CU
REFERENCE		ACSFIPATER43	BK ENCC

↓ RCA TRIM NOMENCLATURE

Product reference		ACSDRCA	APPC
Colour	Black		BK
	White		WH
	Custom		CU
REFERENCE		ACSDRCA	BK APPC

↓ NOMENCLATURES PATERE RCA TRIMLESS

Référence produit	ACSDRCAENCC
-------------------	-------------

Spot mini D

MOUNTING CONFIG.

REF : SD002

SPOT EN

↓ MOUNTING CONFIGURATION

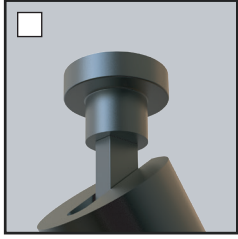

SD002A
Simple peg $\varnothing 24.5\text{mm}$



SD002SMA
Slim track Width 13mm



SD002P
Piccolo track Width 27mm

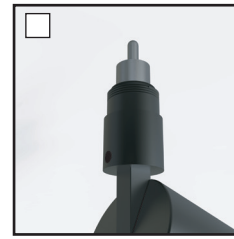

SD002ARCA
RCA

↓ Beam angle

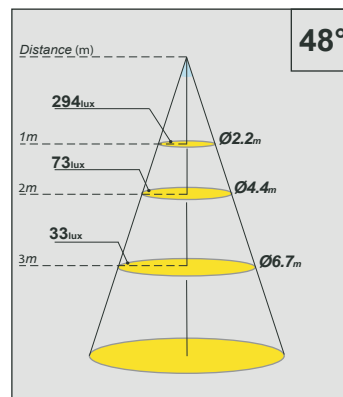
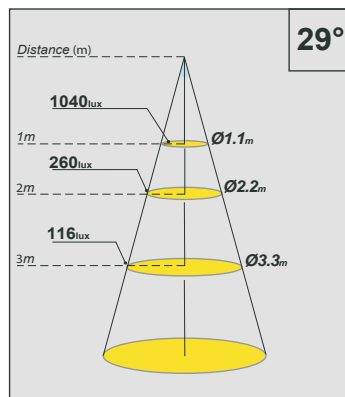
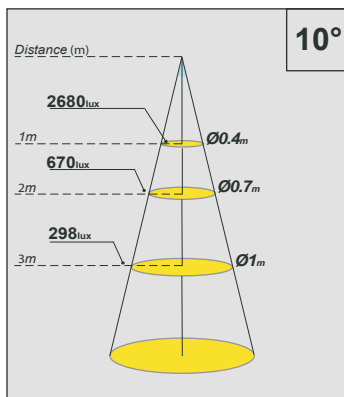

Spot mini D

ORDER REFERENCE

REF : SD002

SPOT EN

ORDER REFERENCE (MOUNTING NOMENCLATURE)

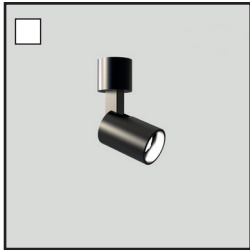

SD002-A-BK-24
Mini D spot - Simple peg - Black(BK) - 2400K(24).

+

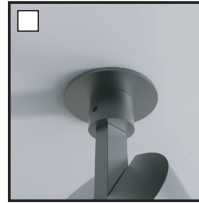

ACSFIPATER43XXENCC
Fixing mounting recessed
Ø43mm H34mm

ou

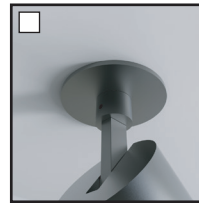

ACSFIPATER60XXENCAC
Fixing mounting recessed
Ø60mm H34mm

ou

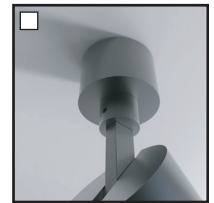

ACSFIPATER50XXAPPC
Fixing mounting ceiling
Ø50mm H30mm

ou

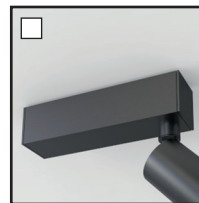

ACSFIPA1704030XXAP1C
Fixing mounting ceiling
(driver in)
x1 spot : 170x40x30mm

ou



ACSFIPA1704030WHAP2C
Fixing mounting ceiling
(driver in)
x2 spots : 170x40x30mm

ORDER REFERENCE (RCA TRIM NOMENCLATURE)



SD002-ARCA-BK-24
Mini D spot - RCA - Black(BK) - 2400K(24).

+



ACSDRCA BKAPPC
Mounting RCA trim - Black(BK)
(Ø50mm)

=



ORDER REFERENCE (RCA TRIMLESS NOMENCLATURE)



SD002-ARCA-BK-24
Mini D spot - RCA - Black(BK) - 2400K(24).

+

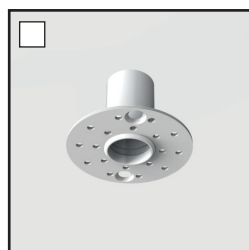

ACSDRCA ENCC
Mounting RCA trimless

=



Spot mini D

ACCESSORIES

REF : SD002

SPOT EN

↓ RCA ACCESSORIES

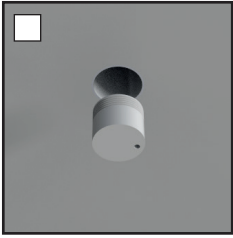

ACSDRCABOUCHONXXC
Finishing cap for RCA trim &
trimless mounting

↓ POWER SUPPLY CONNECTORS

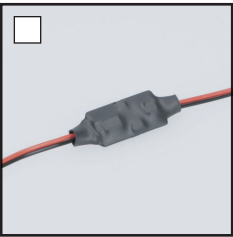

ACSD002COCIRCPXX500
Piccolo circuit with sheath
heat-shrinkable

↓ OPTICAL ACCESSORIES

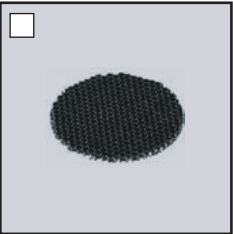

ACCS2NDIDABBK023C
Honeycomb Ø23mm

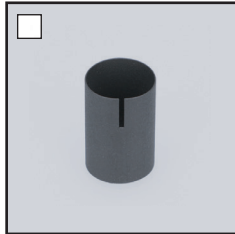

ACSD002SNOOTBKL10C
Mini D Snoot +10mm