

INSTALLATION INSTRUCTIONS
SPOT D10



Read the instructions carefully before assembly and commissioning.



Before proceeding with the installation, please ensure that the meter is powered off for safety reasons.



In accordance with European Union regulations on Waste Electrical and Electronic Equipment (WEEE), this lighting device must be disposed of separately. It should be taken to local collection centers specializing in the disposal or recycling of electronic products.

- Before installing the device, always ensure that the 48V power supply is switched off.
- If you use LOUPI adapters with products from other brands, please note that no responsibility is accepted regarding electrical safety, the proper functioning of the combined system, or any damage resulting from this combination. The liability for any defect in the LOUPI adapter remains unchanged.
- Only the manufacturer is authorized to replace or repair the LED module of this lighting device. In the event of damage or failure of the LED module, the entire lighting device must be returned to the factory.
- Please follow national guidelines for installation and accident prevention.
- This lighting device is intended for indoor use only in dry environments.
- When cleaning, please use only a high-quality microfiber cloth suitable for precision optical systems.

SD010

SIMPLE PEG INSTALLATION



Do not install on plasterboard

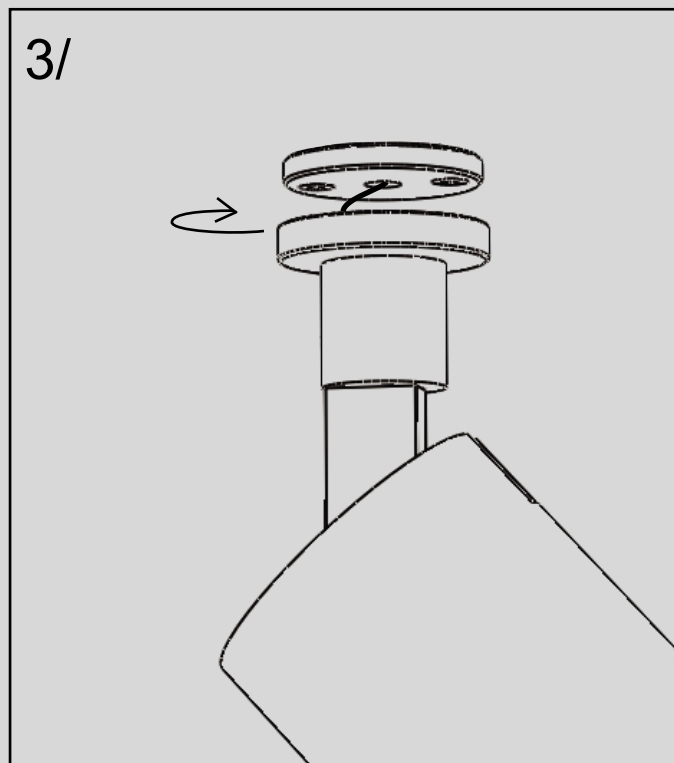
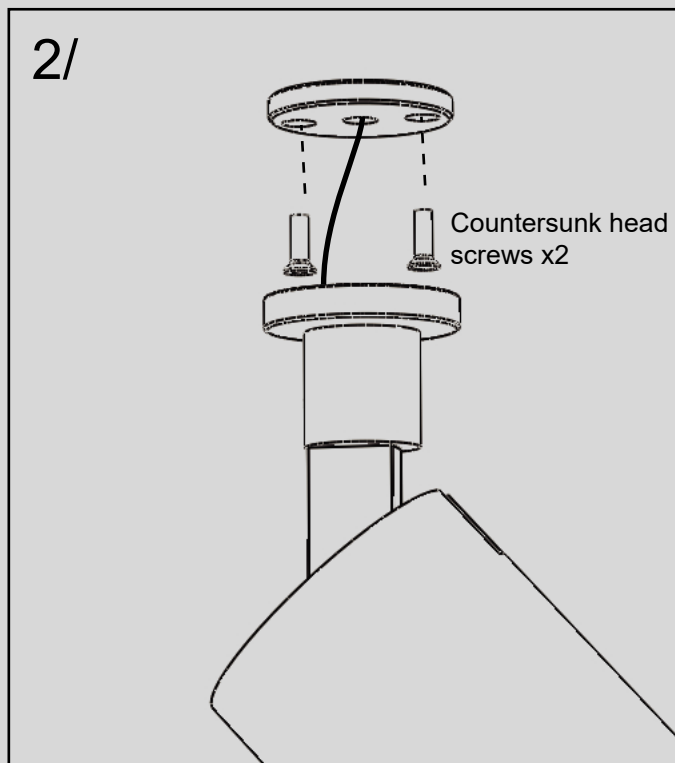
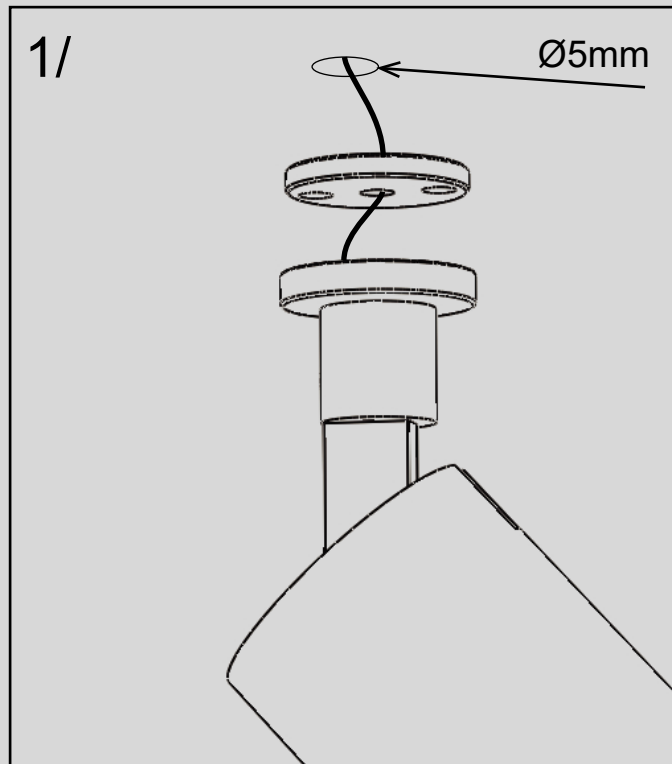
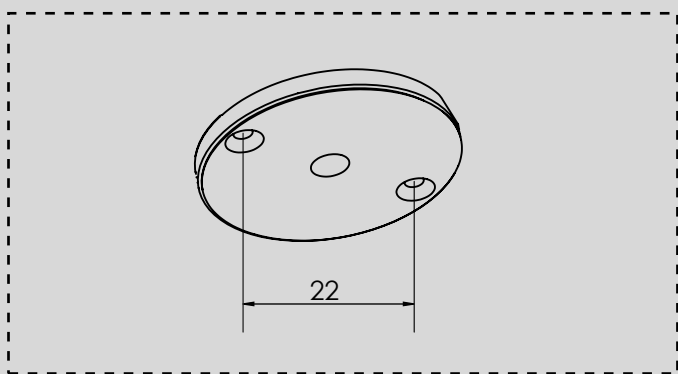

SD010

CEILING PEG INSTALLATION Ø50

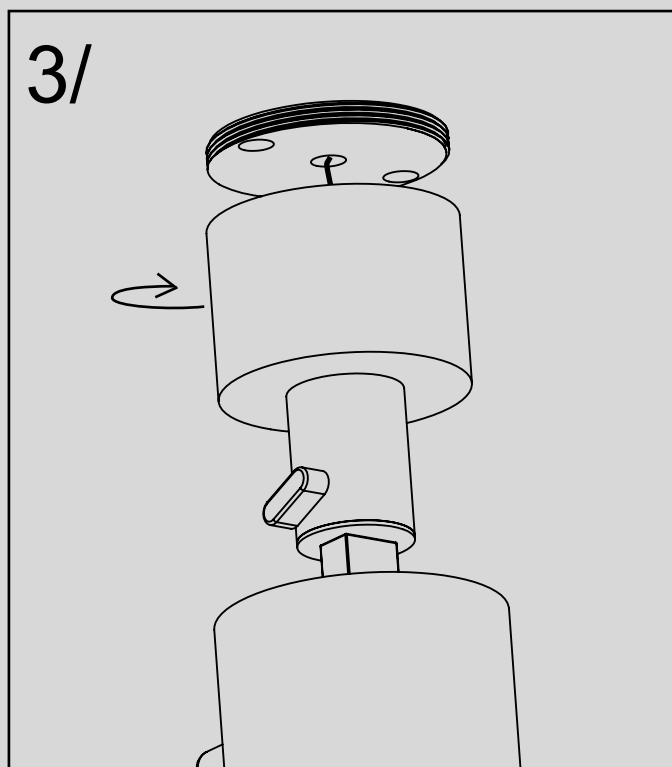
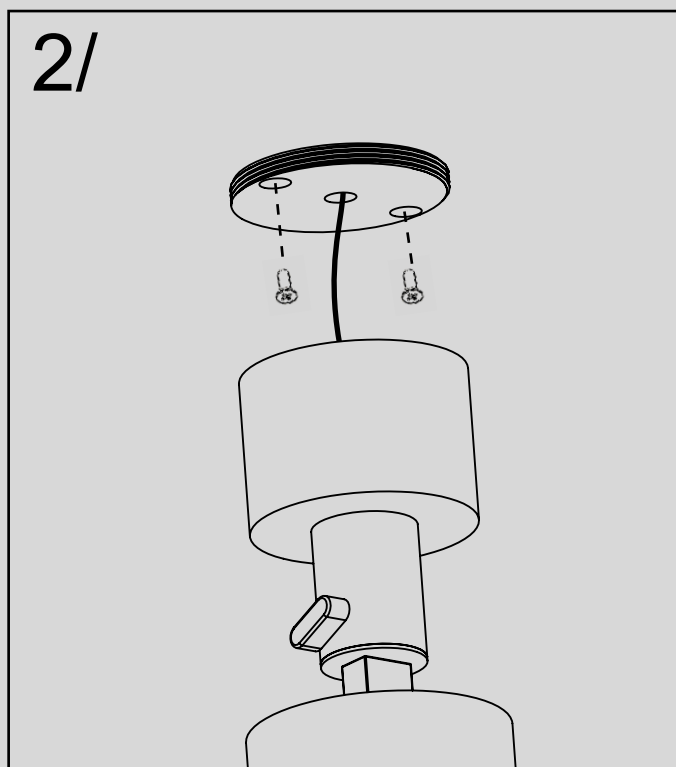
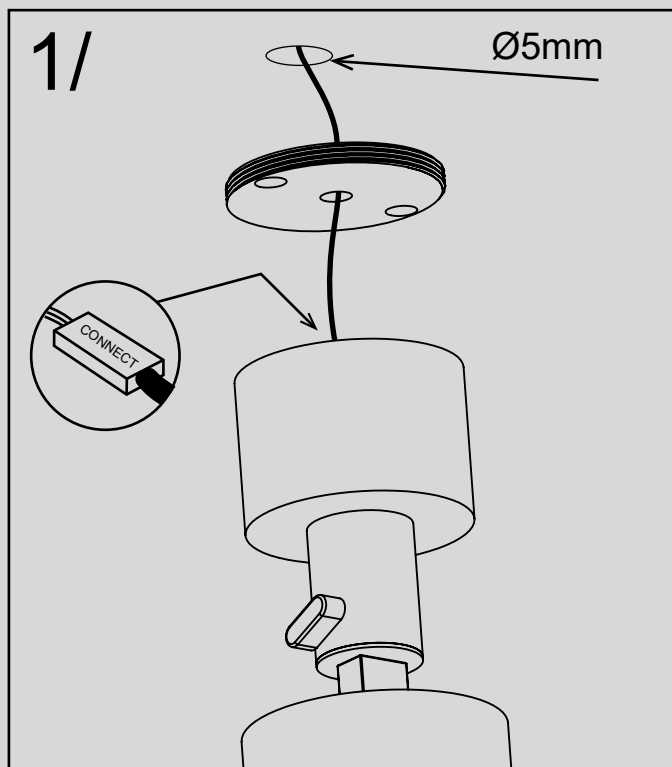
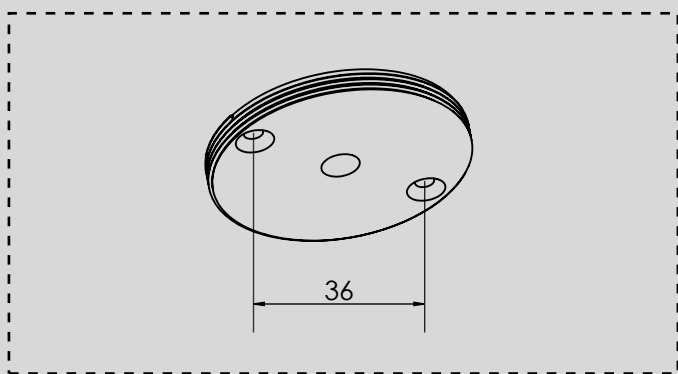

SD010

RECESSED PEG INSTALLATION Ø43 AND Ø60

1/

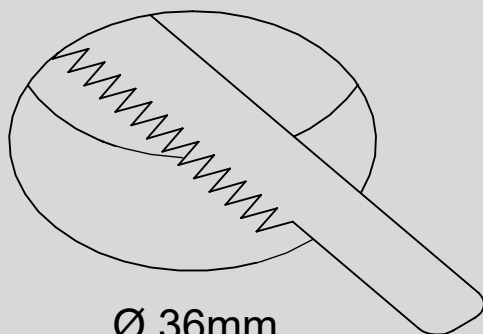

Ø 36mm

PEG Ø43

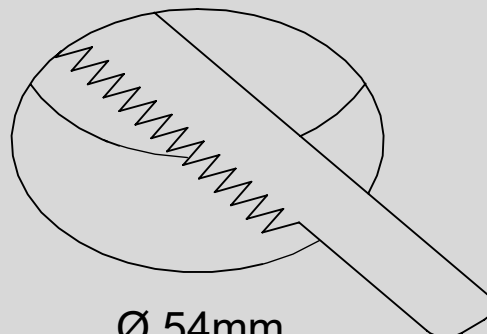

Ø 54mm

PEG Ø60

2/

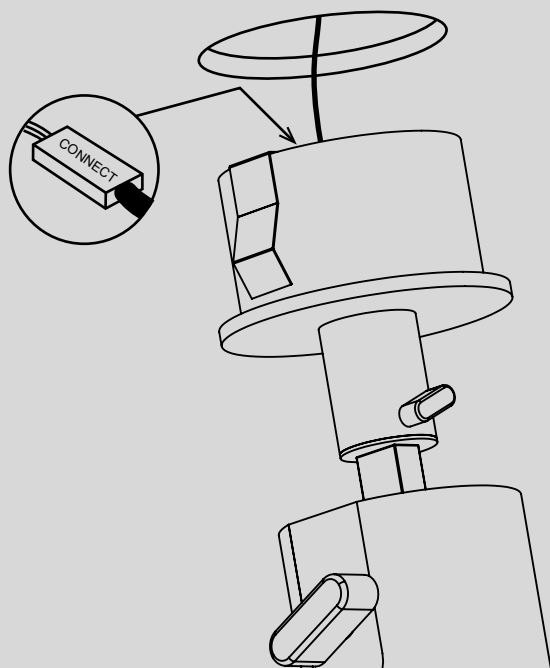

3/

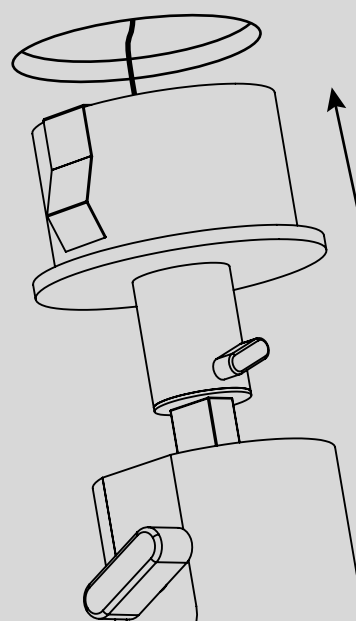

SD010

INSTALLATION ON TRACK

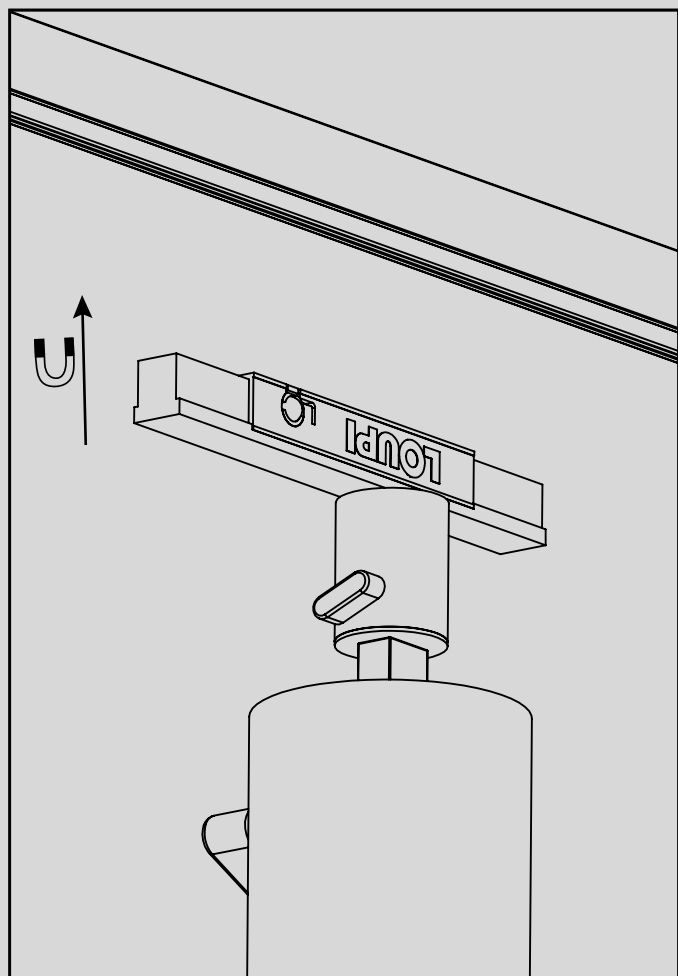

RAIL SLIM

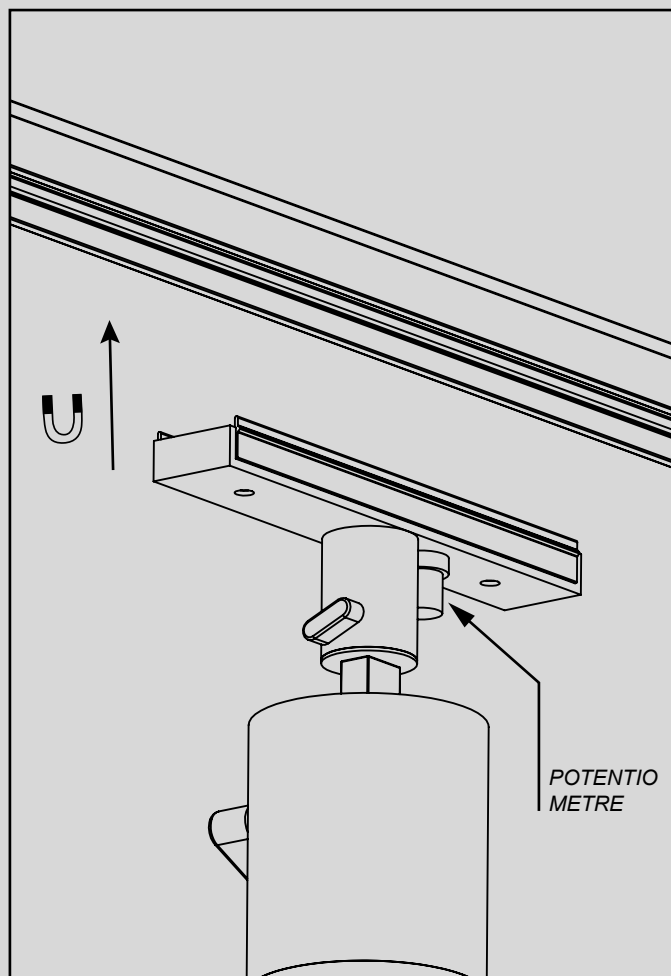

RAIL PICCOLO

SD010

RCA TRIM INSTALLATION

1/

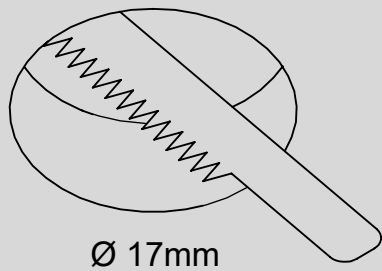

2/

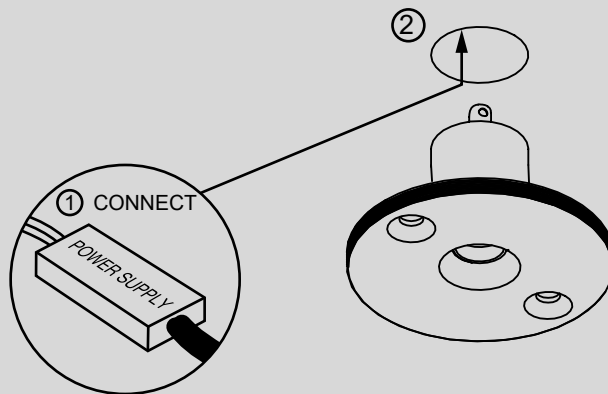

3/

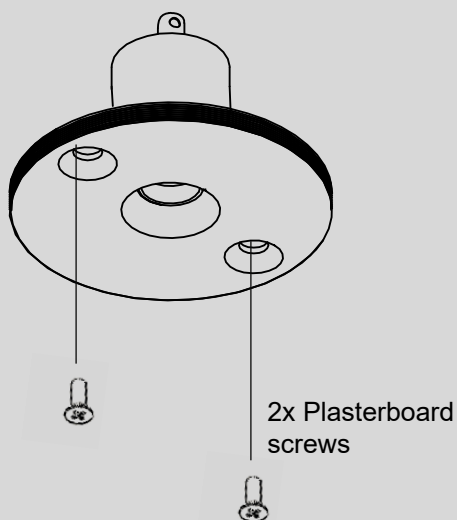

4/

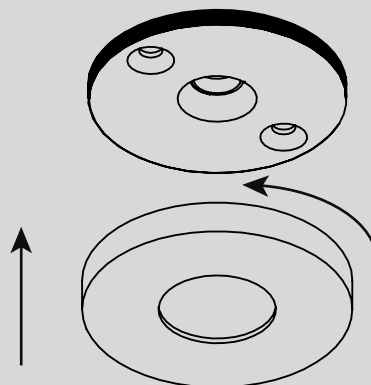

5/

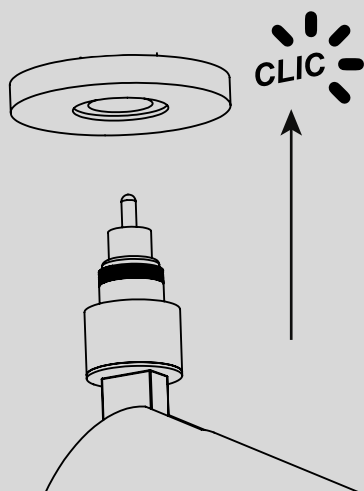

Finishing cap to be installed when no spotlight is connected

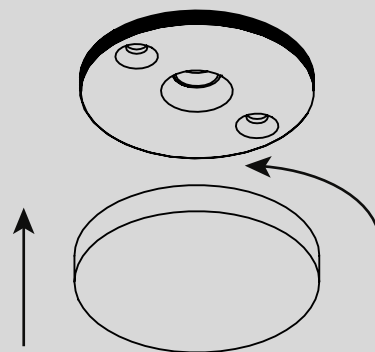

SD010

RCA TRIMLESS INSTALLATION

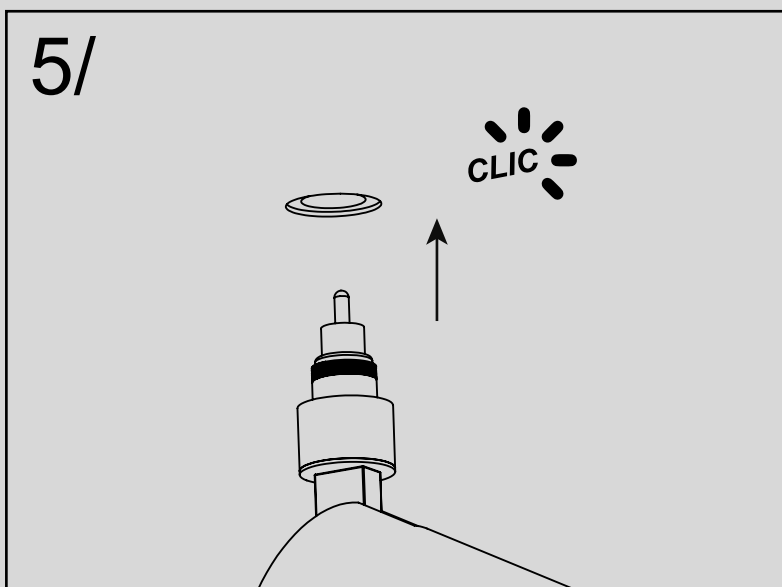
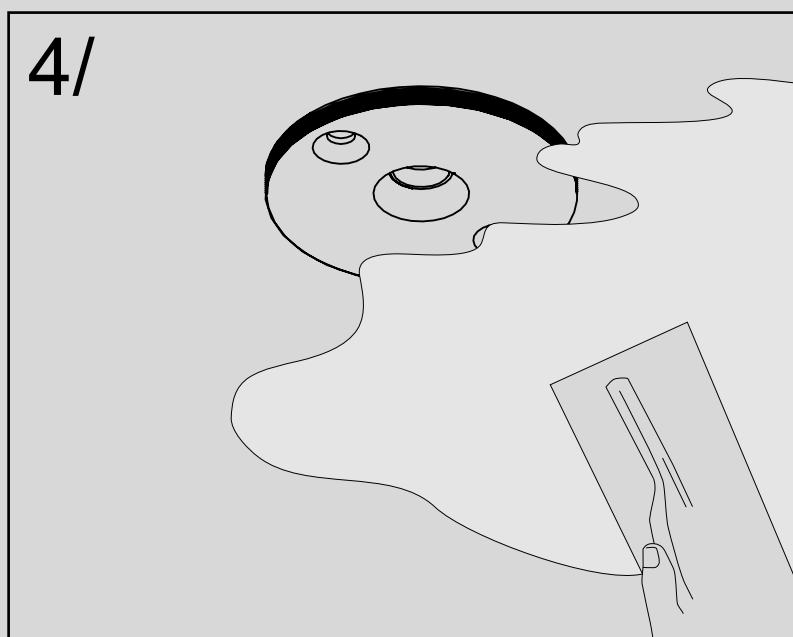
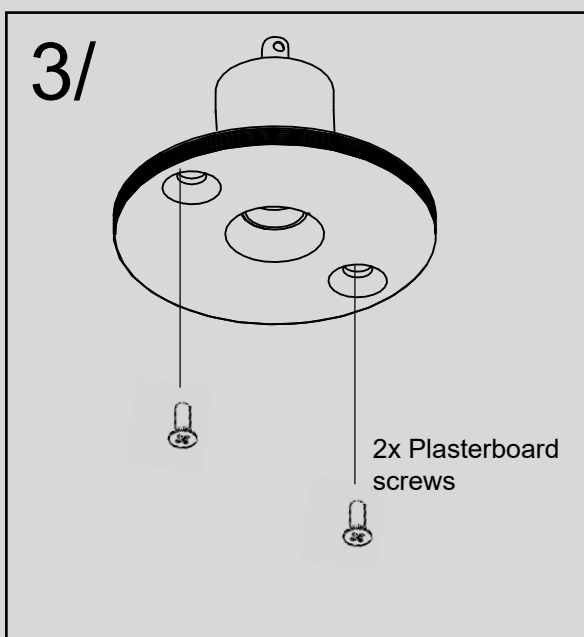
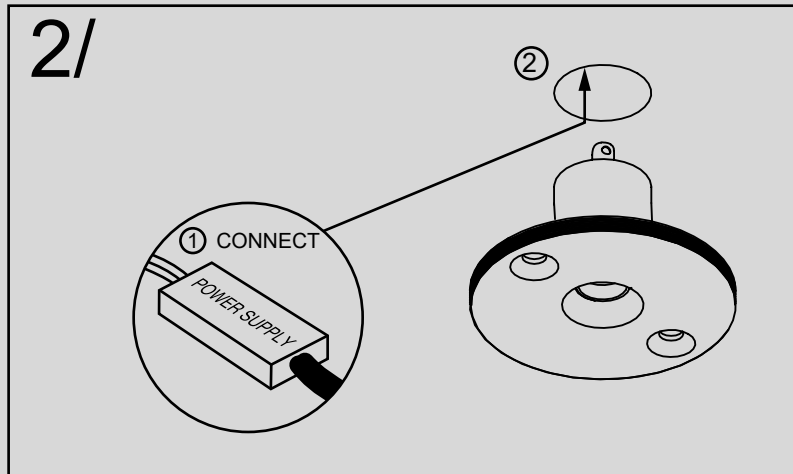
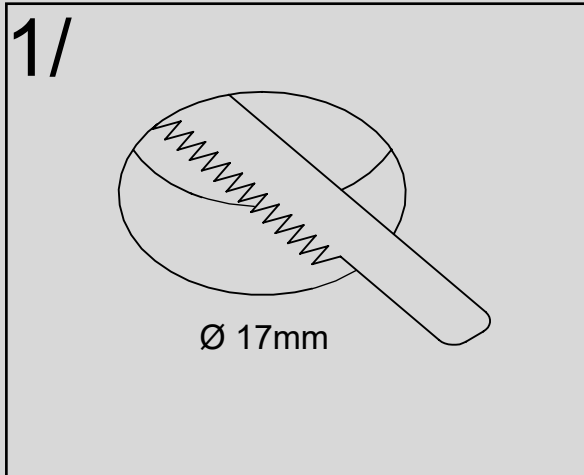

SD010

INSTALLATION OF THE FRAMING ACCESSORY

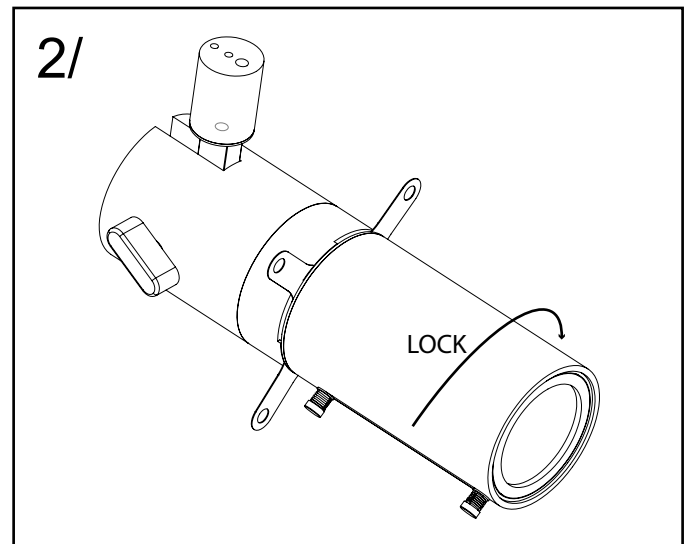
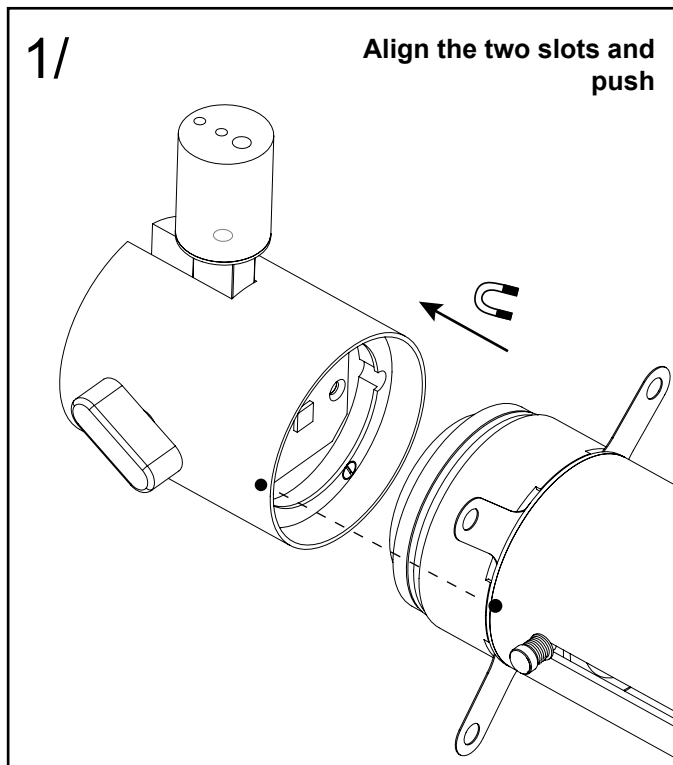

GOBO INSTALLATION

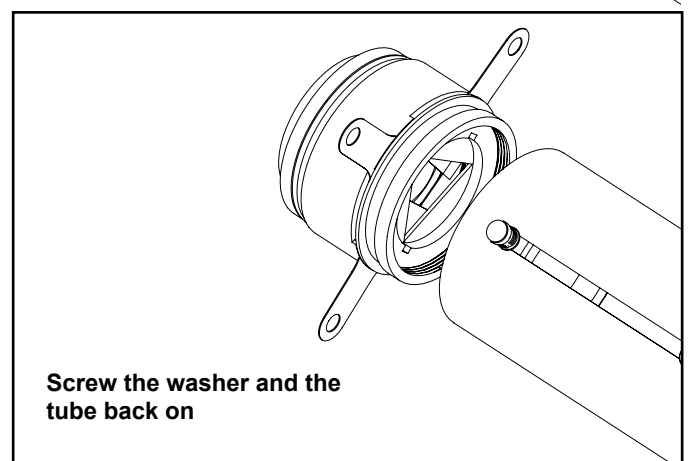
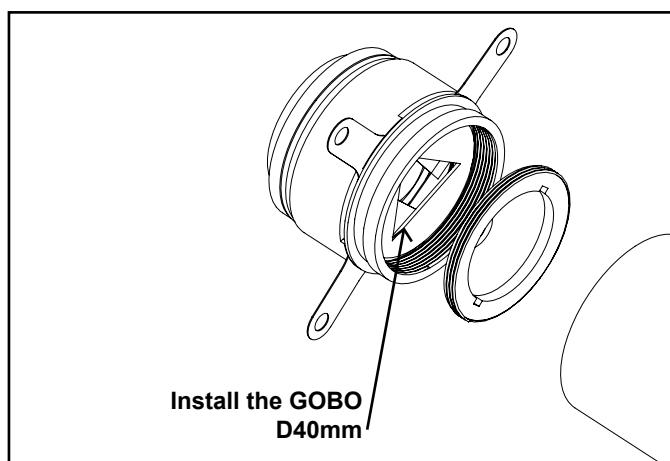
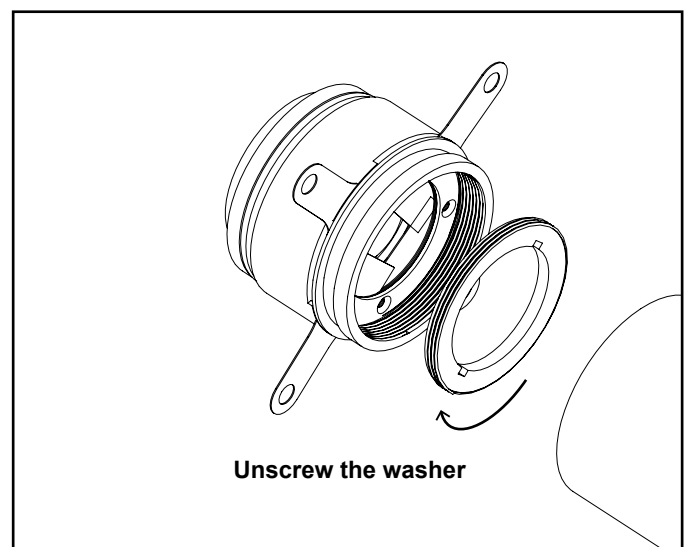
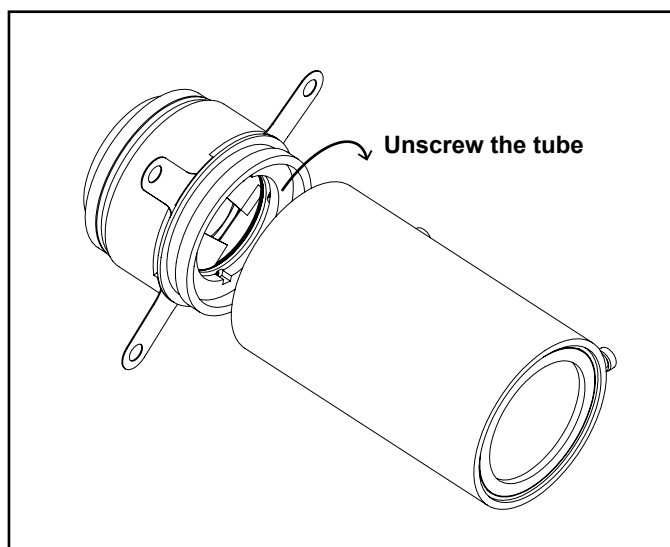

SD010

INSTALLATION OF THE FRAMING ACCESSORY

FILTER INSTALLATION

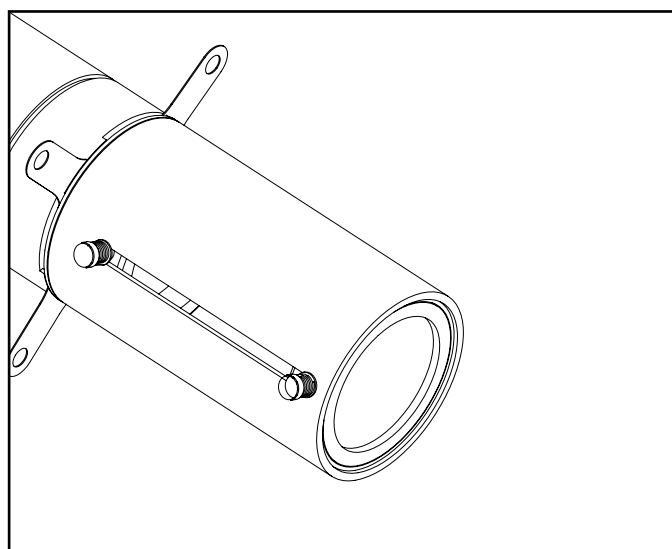
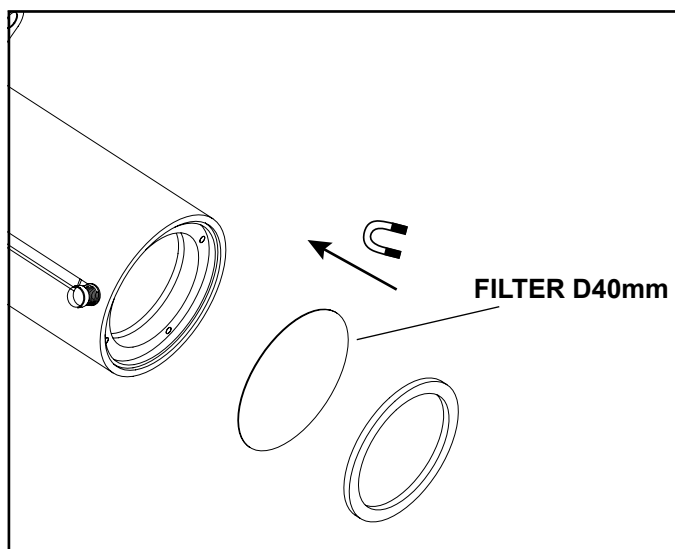

SD010

INSTALLATION OF THE F10 ACCESSORY

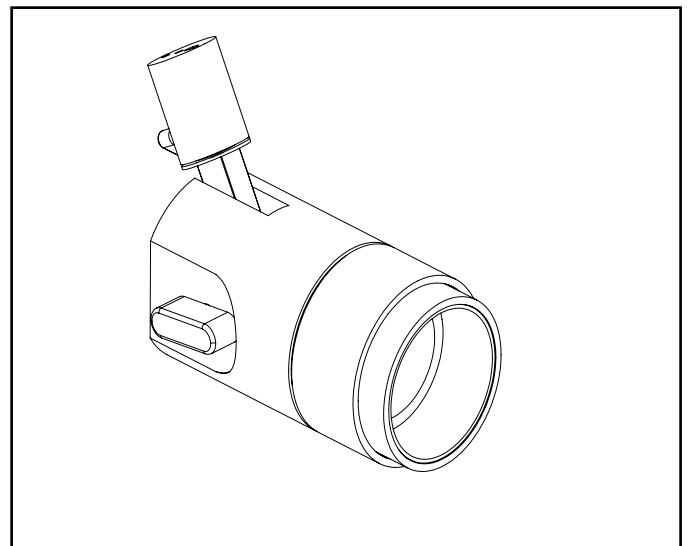
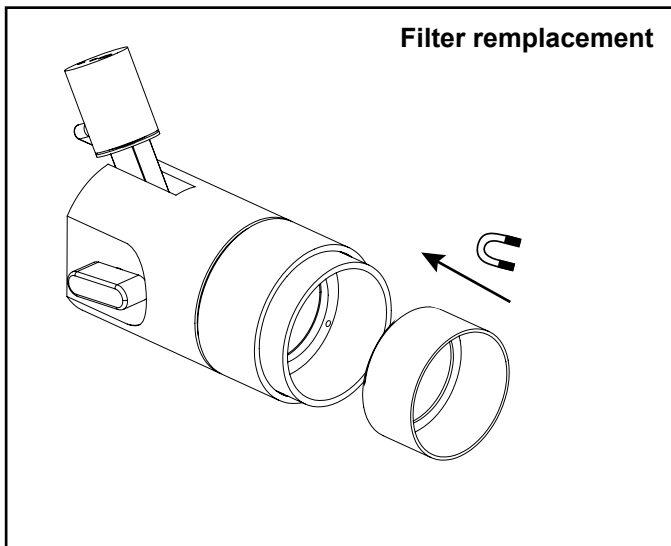
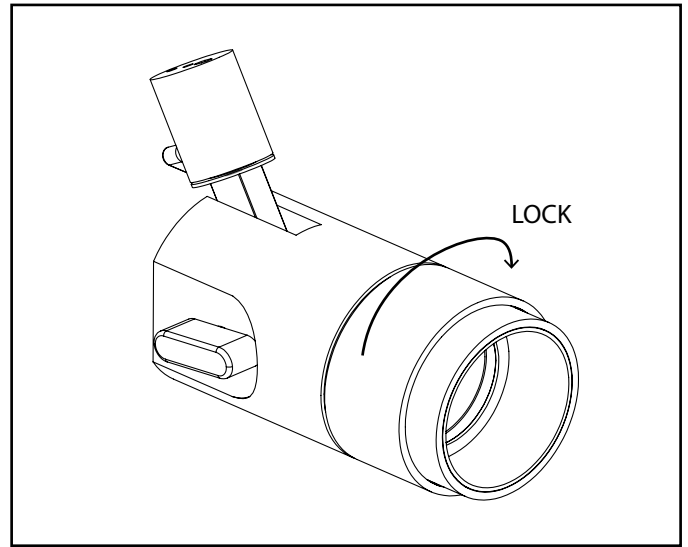
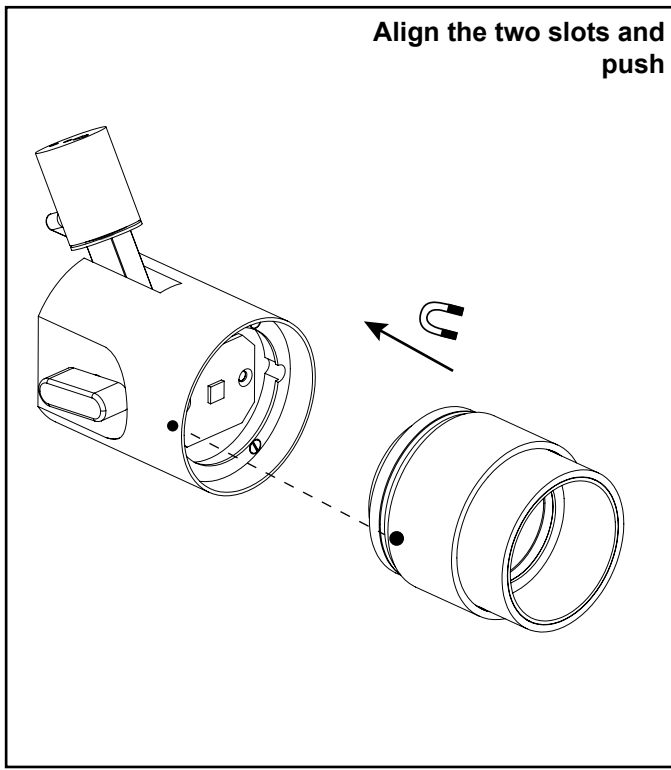

SD010

INSTALLATION OF THE LENS HOLDER ACCESSORY

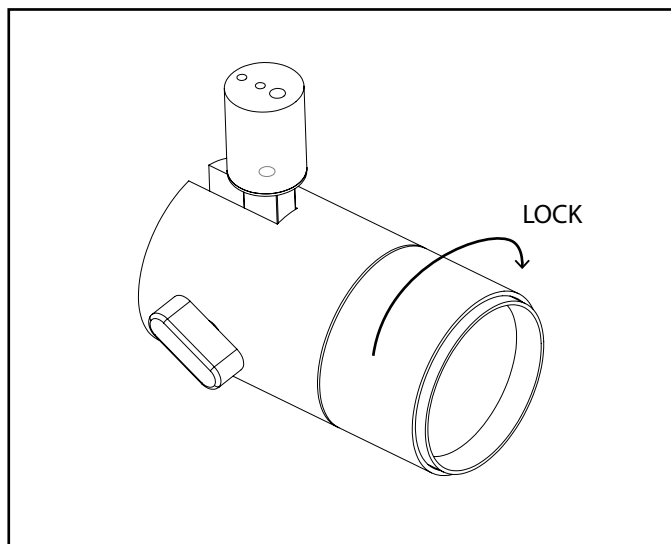
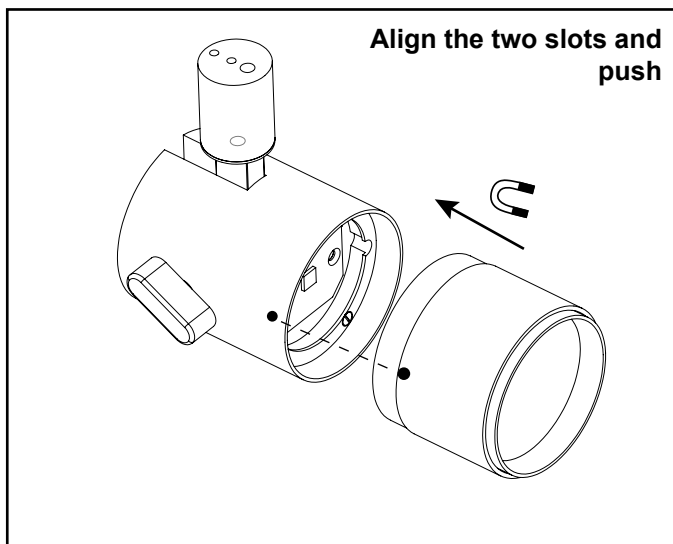

SD010

INSTALLATION OF THE WALLWASHER ACCESSORY

