

Spot D15

REF : SD015

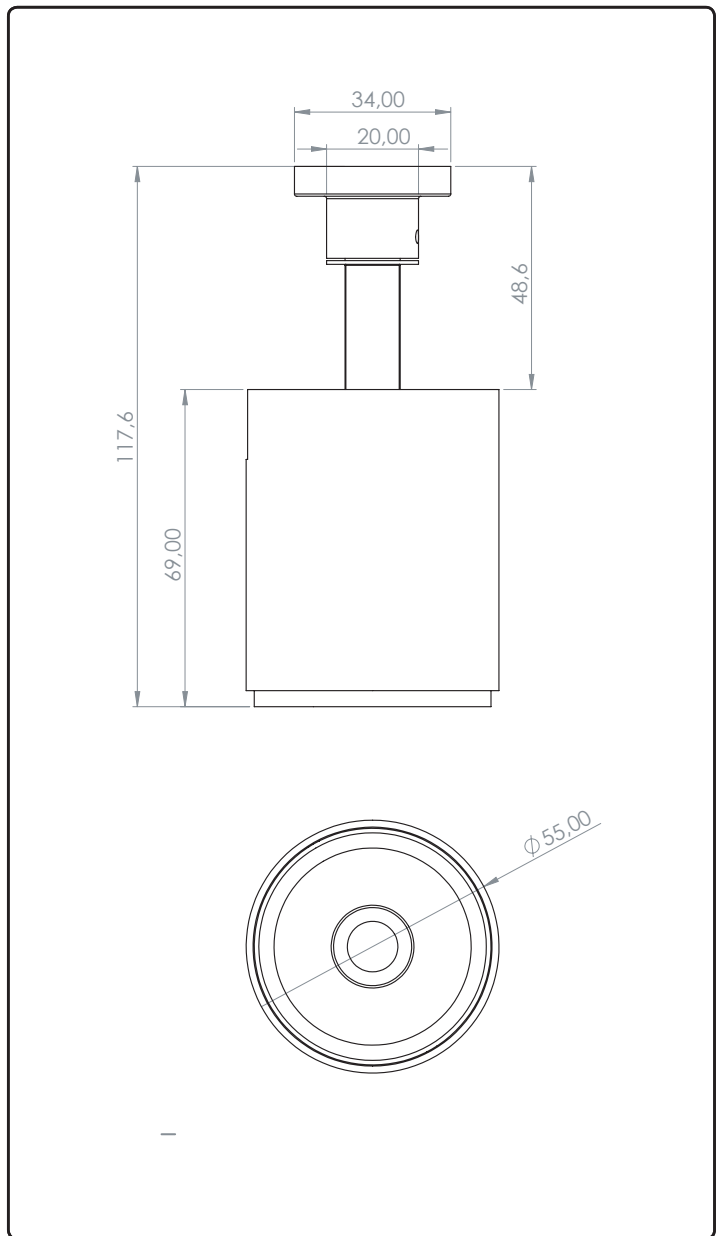

↓ PRODUCT DESCRIPTION

Spot D15 - Powerful LED accent and architectural round spotlight with adjustable aluminium body. Threaded safety lock. Passive heat dissipation for source temperature control preserving LED life. Interchangeable lenses by simple magnetic contact.

↓ OUTPUT (PEG)



↓ OUTPUT (TRACK, RCA)

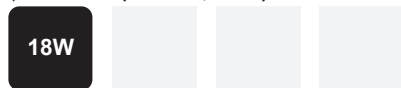

↓ CRI



↓ USE



↓ IP



↓ POWER SUPPLY (PEG)

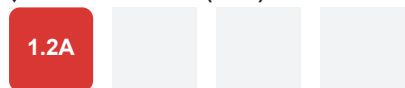

↓ LUMENS



↓ ADJUSTABLE DEGREES



↓ POWER SUPPLY (TRACK, RCA)



↓ DIMMING



↓ COLOUR TEMPERATURE



↓ STANDARDS COMPLIANCE



↓ COLOURS



↓ SOURCES

- Luminous flux according to Bining: 1500lumens
- Colour temperature : de 2700K to 4000K
- Service Range: 70 % of nominal flux after 50 000 hours
- Colour Rendering Index: CRI 90

↓ OPTICAL

- PMMA acrylic lens, efficiency ~90%
- Adjustable degrees : 10°, 15°, 25°, 35° and Elliptic

↓ ELECTRICAL (on peg)

- Power supply 1.2A
- Reversible polarity and hot plug
- Power consumption to 15W max, excluding supply
- Electrical Classification : Class III SELV device

↓ ELECTRICAL (on tracks or RCA)

- Power supply 24V
- Electric transmission by magnetic contact
- Reversible polarity and hot plug
- Power consumption to 18W max, excluding supply
- Electrical Classification : Class III SELV device

↓ MECHANICAL

- Electronic circuit encased in a fire-proof polycarbonate housin
- Fixing by magnetic contact (on track)
- Operating temperature : -5° +40°
- Articulating base
- ROHS components
- Interior use only

↓ SPECIFICITIES

- 3 years guarantee

↓ SPOT NOMENCLATURE

Product Ref.	SD015		
Product specification	Simple peg	A	
	RCA	ARCA	
	Piccolo track	P	
	Slim track magnet	SMA	
	220 0-10V track	RV	
	220 DALI track	RD	
Colour	Black	BK	
	White	WH	
	Custom	CU	
Temperature	2700K	27	
	3000K	30	
	3500K	35	
	4000K	40	
Degrees	10°	10	
	15°	15	
	25°	25	
	35°	35	
	Elliptic	ELL	
REFERENCE	SD015	A	BK 27 10

↓ MOUNTING NOMENCLATURE

Mounting spec.	Mounting recessed Ø43	ACSFIPATER43	ENCC
	Mounting recessed Ø60	ACSFIPATER60	ENCAC
	Mounting ceiling Ø50	ACSFIPATER50	APPC
	Mounting ceiling X1spot	ACSFIPA1704030	AP1C
	Mounting ceiling X2spot	ACSFIPA1704030	AP2C
Colour	Black	BK	
	White	WH	
	Custom	CU	
REFERENCE		ACSFIPATER43	BK ENCC

↓ RCA TRIM NOMENCLATURE

Product reference	ACSDRCA	APPC
Colour	Black	BK
	White	WH
	Custom	CU
REFERENCE	ACSDRCA	BK APPC

↓ NOMENCLATURES PATERE RCA TRIMLESS

Référence produit	ACSDRCAENCC
-------------------	-------------

Spot D15

MOUNTING CONFIG.

REF : SD015



↓ MOUNTING CONFIGURATION

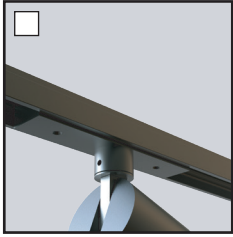

SD015P
Piccolo track Width 27mm

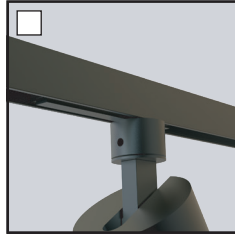

SD015SMA
Slim track Width 13mm

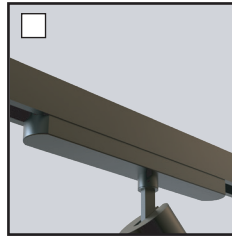

SD015RV
220 0-10V track Width 31mm

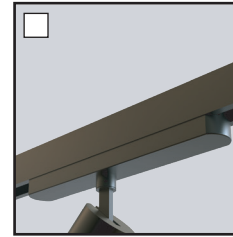

SD015RD
220 DALI track Width 31mm

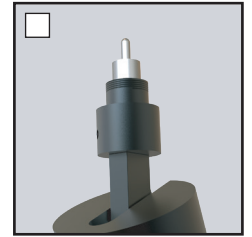

SD015ARCA
RCA

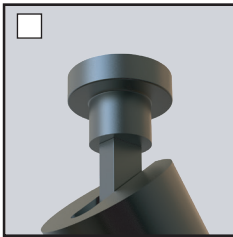

SD015A
Simple peg
Ø35mm H21mm

↓ Beam angle

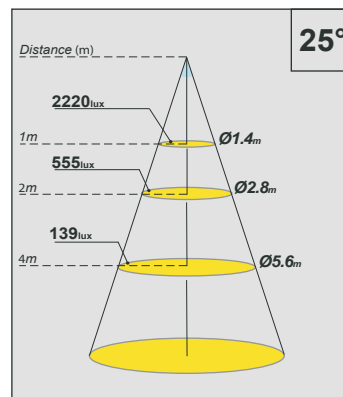
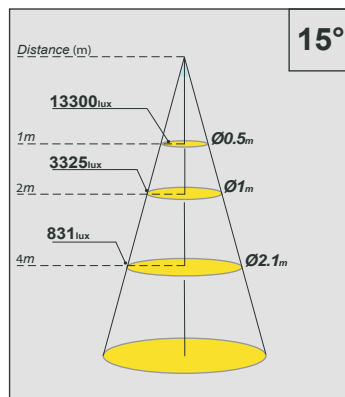
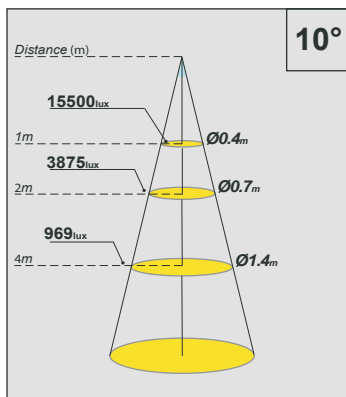

Spot D15

ORDER REFERENCE

REF : SD015



ORDER REFERENCE (MOUNTING NOMENCLATURE)

SD015-A-BK-27
Spot D15 - Peg - Black(BK) - 2700K(27).

ACSFIPATER43XXENCC
Fixing mounting recessed
Ø43mm H34mm

ACSFIPATER60XXENCAC
Fixing mounting recessed
Ø60mm H34mm

ACSFIPATER50XXAPPC
Fixing mounting ceiling
Ø50mm H30mm

ACSFIPA1704030XXAP1C
Fixing mounting ceiling (driver in)
x1 spot : 170x40x30mm

ACSFIPA1704030WHAP2C
Fixing mounting ceiling (driver in)
x2 spots : 170x40x30mm

ORDER REFERENCE (RCA TRIM NOMENCLATURE)

SD015-ARCA-BK-27
Spot D15 - RCA - Black(BK) - 2700K(27).

ACSDRCABKAPPC
Mounting RCA trim - Black(BK)
(Ø50mm)

ORDER REFERENCE (RCA TRIMLESS NOMENCLATURE)

SD015-ARCA-BK-27
Spot D15 - RCA - Black(BK) - 2700K(27).

ACSDRCAENCC
Mounting RCA trimless

Spot D15

ACCESSORIES

REF : SD015

SPOT

EN

↓ RCA ACCESSORIES

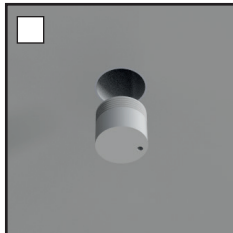

ACSDRCABOUCHONXXC
Finishing cap for RCA trim &
trimless mounting

↓ POWER SUPPLY CONNECTORS

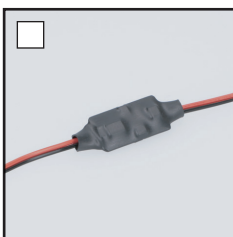

ACSD015COCIRCPXX500
Piccolo circuit with sheath
heat-shrinkable

↓ OPTICAL ACCESSORIES

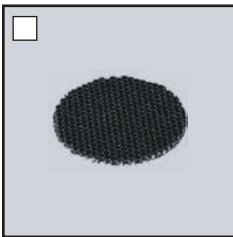

ACSD015NIDABBK050C
Honeycomb Ø49.5mm

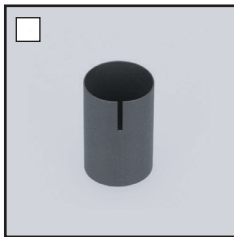

ACSD015OPSNOOTBKL10C
Snoot spot D15 +10mm