

Insert minimal

REF : IN00-MI

RECESSED

EN



↓ PRODUCT DESCRIPTION

Insert Minimal is a 4W mini recessed spotlight designed for the most discreet projects. Once installed trimless, its visible diameter is only 15 mm. Installation is simple, and the spotlight remains removable thanks to a clever spring system, making maintenance or replacement easy.

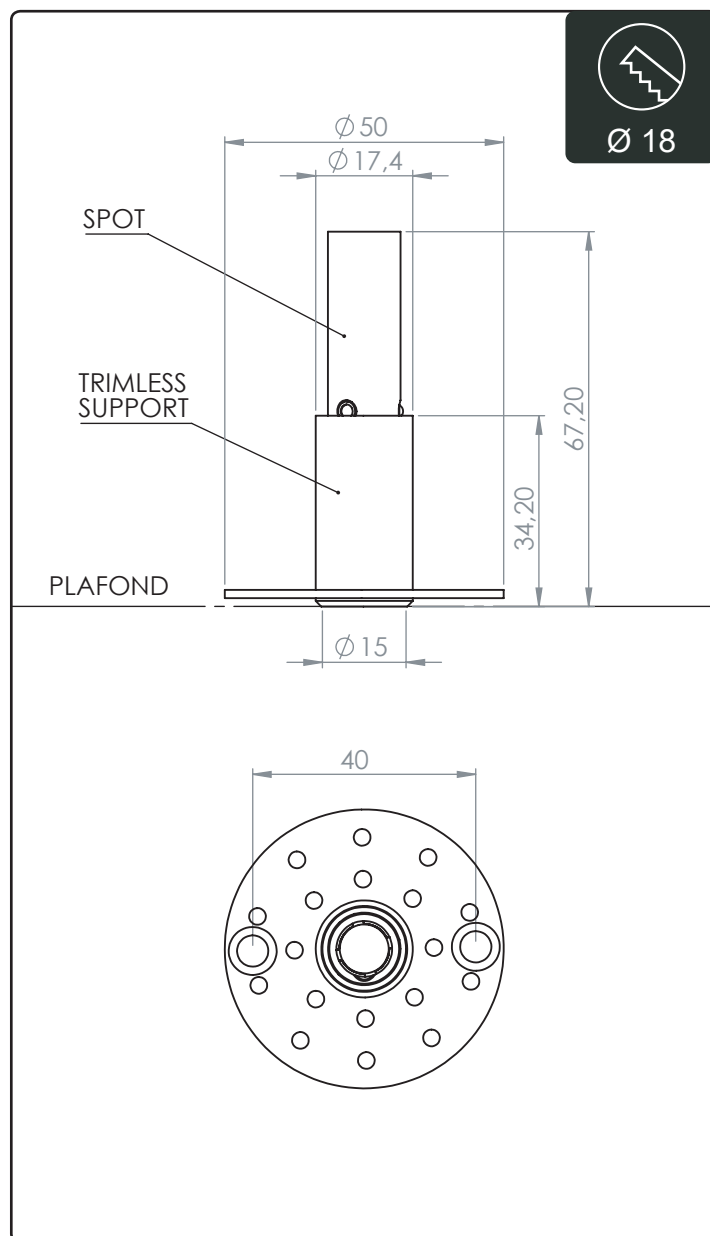

↓ OUTPUT

4W

↓ LUMENS

400lm

↓ CRI

IRC90

↓ POWER SUPPLY

1.3A

↓ IP

IP 40

↓ DEGREES

16°

24°

40°

ELL

↓ DIMMING



DMX

↓ USE



↓ TEMPÉRATURES DE COULEUR

2400K

2700K

3000K

3500K

4000K

5000K

↓ STANDARDS COMPLIANCE

EN 62471

EN 60598-1

EN 60598-2

CE

III

↓ COLOURS

BK

WH

CUSTOM

LOUPI LIGHTING

Designed and manufactured by Loupi Lighting, all rights reserved.
Trademarks, models, and patents registered, reproduction prohibited.
Non-contractual document. Specifications may be subject to change without prior notice.

+33 1 49 15 99 99
contact@loupi.com
www.loupi-lighting.com

↓ SOURCES

- Luminous flux according to Bining : **400**lumens;
- Colour temperature : de **2400K à 5000K**
- Service Range: 70 % of nominal flux after 50 000 hours
- Rendering Index: CRI 90

↓ OPTICAL

- PMMA acrylic lens, efficiency ~90%
- Degrees : **16°, 24°, 40° et Elliptique**

↓ ÉLECTRIQUES

- Power supply **1.3A**
- Reversible polarity and hot plug
- Power consumption to **4W** max, excluding supply
- Electrical Classification : Class III SELV device

↓ MECHANICAL

- Electronic circuit encased in a fire-proof polycarbonate housin
- Operating temperature : -5° +40°
- ROHS components
- Interior use only

↓ SPECIFICITIES

- 3 years guarantee

↓ NOMENCLATURE

Product ref	IN00				
Specificities product		MI			
Degrees	16°			16	
	24°			24	
	40°			40	
	Elliptic			ELL	
Colour	Noir			BK	
	Blanc			WH	
	Custom			CU	
Temperature	2400K				24
	2700K				27
	3000K				30
	3500K				35
	4000K				40
	5000K				50
REFERENCE	IN00	MI	40	BK	24

↓ BEAN ANGLE

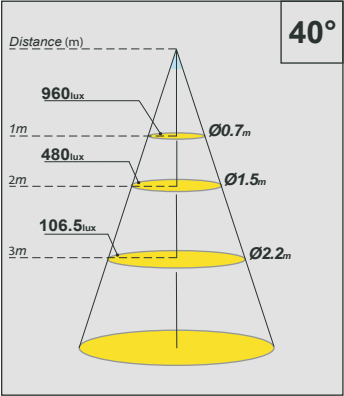
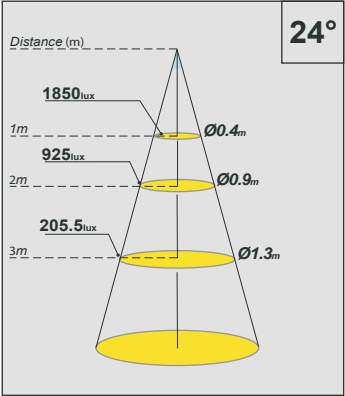
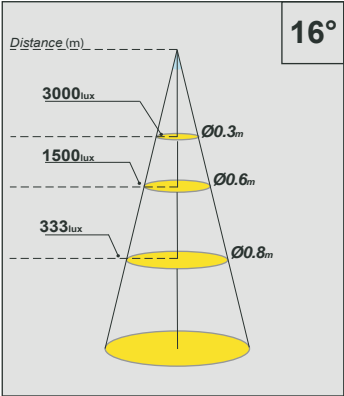

↓ POWER SUPPLY CONNECTORS

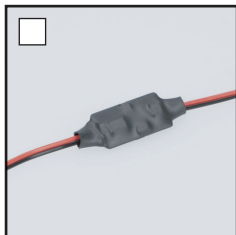

ACIN00COCIRCPXX500

Piccolo circuit with sheath
heat-shrinkable