

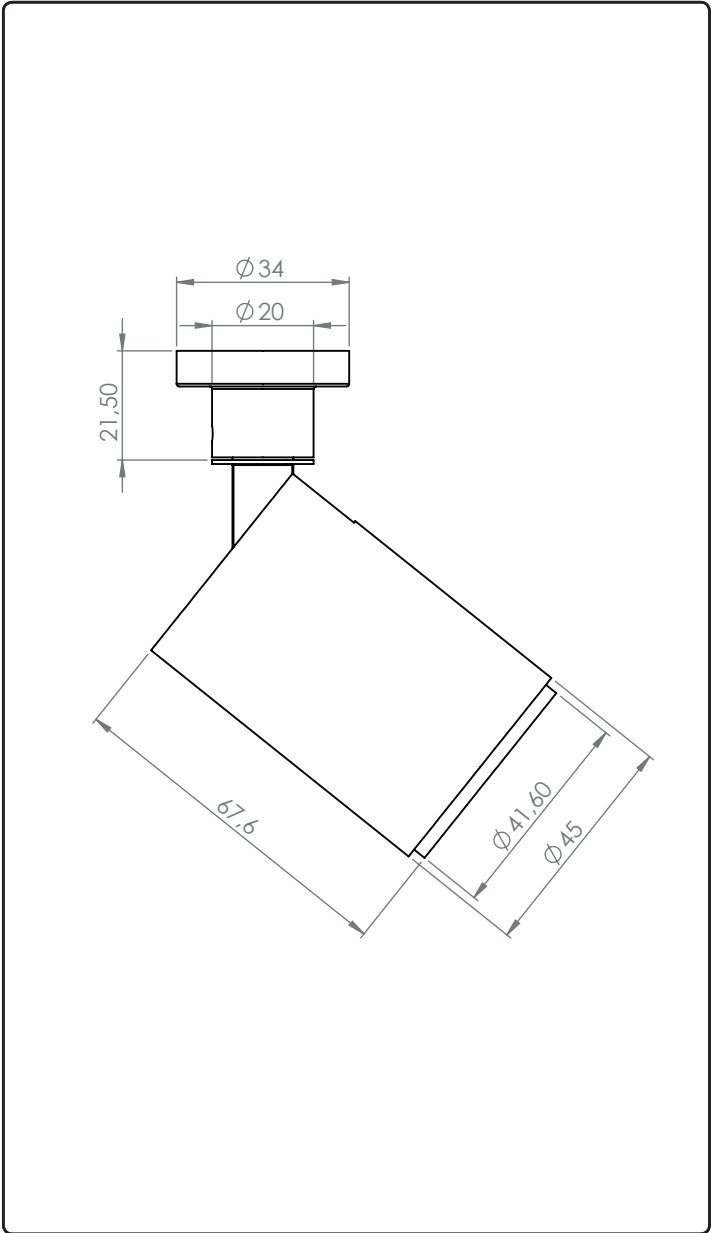

↓ PRODUCT DESCRIPTION

Spot D12 - Powerful LED accent and architectural round spotlight with adjustable aluminium body. Threaded safety lock. Passive heat dissipation for source temperature control preserving LED life. Interchangeable lenses (15°, 25°, 40°, 50° Elliptical) by simple magnetic contact.



↓ OUTPUT (PEG)



↓ OUTPUT (TRACK, RCA)



↓ CRI



↓ USE



↓ IP



↓ POWER SUPPLY (PEG)

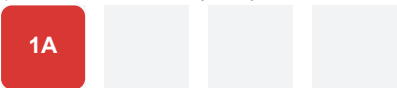

↓ LUMENS



↓ ADJUSTABLE DEGREES



↓ POWER SUPPLY (TRACK, RCA)

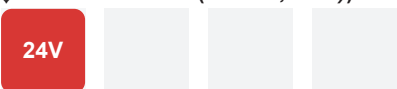

↓ DIMMING



↓ COLOUR TEMPERATURE



↓ STANDARDS COMPLIANCE



↓ COLOURS



↓ SOURCES

- Luminous flux according to Bining: 1200lumens
- Colour temperature : de 2700K to 4000K
- Service Range: 70 % of nominal flux after 50 000 hours
- Colour Rendering Index: CRI 90

↓ OPTICAL

- PMMA acrylic lens, efficiency ~90%
- Adjustable degrees : 15°, 25°, 40°, 50° and Elliptic

↓ ELECTRICAL (on peg)

- Power supply 1A
- Reversible polarity and hot plug
- Power consumption to 12W max, excluding supply
- Electrical Classification : Class III SELV device

↓ ELECTRICAL (on tracks or RCA)

- Power supply 24V
- Electric transmission by magnetic contact
- Reversible polarity and hot plug
- Power consumption to 14.5W max, excluding supply
- Electrical Classification : Class III SELV device

↓ MECHANICAL

- Electronic circuit encased in a fire-proof polycarbonate housin
- Fixing by magnetic contact (on track)
- Operating temperature : -5° +40°
- Articulating base
- ROHS components
- Interior use only

↓ SPECIFICITIES

- 3 years guarantee

↓ SPOT NOMENCLATURE

| | | | | | |
|-----------------------|-------------------|------|----|-----|----|
| Product Ref. | SD012 | | | | |
| Product specification | Simple peg | A | | | |
| | RCA | ARCA | | | |
| | Piccolo track | P | | | |
| | Slim track magnet | SMA | | | |
| | 220 0-10V track | RV | | | |
| | 220 DALI track | RD | | | |
| Colour | Black | BK | | | |
| | White | WH | | | |
| | Custom | CU | | | |
| Temperature | 2700K | | 27 | | |
| | 3000K | | 30 | | |
| | 3500K | | 35 | | |
| | 4000K | | 40 | | |
| Degrees | 15° | | | 15 | |
| | 25° | | | 25 | |
| | 40° | | | 40 | |
| | 50° | | | 50 | |
| | Elliptic | | | ELL | |
| REFERENCE | SD012 | A | BK | 27 | 15 |

↓ MOUNTING NOMENCLATURE

| | | | | | |
|----------------|-------------------------|----------------|-------|------|--|
| Mounting spec. | Mounting recessed Ø43 | ACSFIPATER43 | ENCC | | |
| | Mounting recessed Ø60 | ACSFIPATER60 | ENCAC | | |
| | Mounting ceiling Ø50 | ACSFIPATER50 | APPC | | |
| | Mounting ceiling X1spot | ACSFIPA1704030 | AP1C | | |
| | Mounting ceiling X2spot | ACSFIPA1704030 | AP2C | | |
| Colour | Black | | BK | | |
| | White | | WH | | |
| | Custom | | CU | | |
| REFERENCE | | ACSFIPATER43 | BK | ENCC | |

↓ RCA TRIM NOMENCLATURE

| | | | | | |
|-------------------|--------|---------|----|------|--|
| Product reference | | ACSDRCA | | APPC | |
| Colour | Black | | BK | | |
| | White | | WH | | |
| | Custom | | CU | | |
| REFERENCE | | ACSDRCA | BK | APPC | |

↓ NOMENCLATURES PATERE RCA TRIMLESS

| | |
|-------------------|-------------|
| Référence produit | ACSDRCAENCC |
|-------------------|-------------|

Spot D12

MOUNTING CONFIG.

REF : SD012



↓ MOUNTING CONFIGURATION

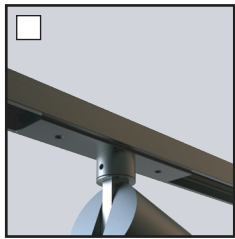

SD012P
Piccolo track Width 27mm

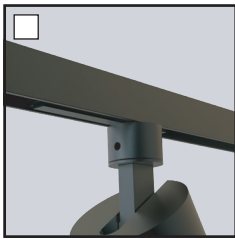

SD012SMA
Slim track Width 13mm

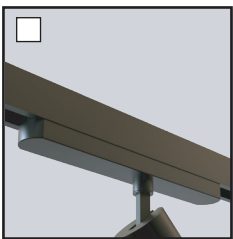

SD012RV
220 0-10V track Width 31mm

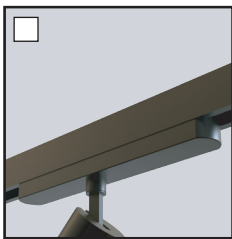

SD012RD
220 DALI track Width 31mm

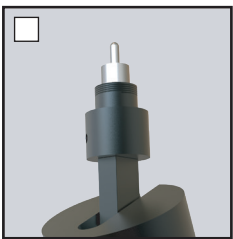

SD012ARCA
RCA

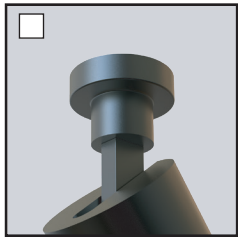

SD012A
Simple peg
Ø35mm H21mm

↓ Beam angle

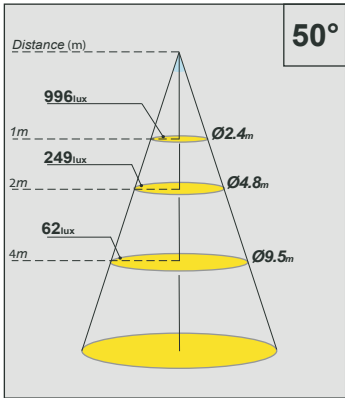
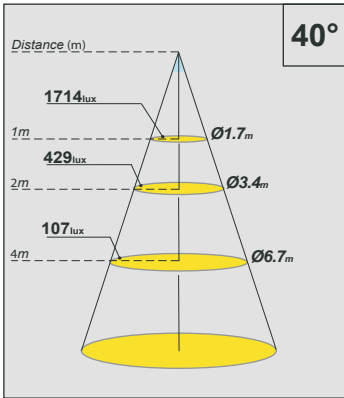
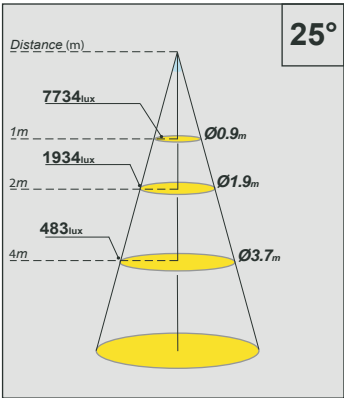
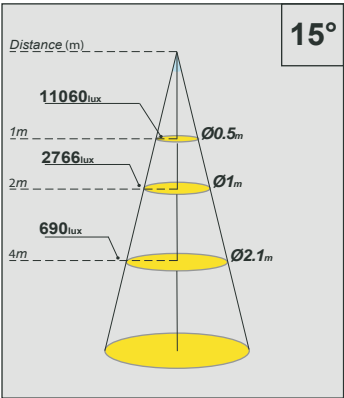

Spot D12

ORDER REFERENCE

REF : SD012



ORDER REFERENCE (MOUNTING NOMENCLATURE)

SD012-A-BK-27
Spot D12 - Peg - Black(BK) - 2700K(27).

+

ACSFIPATER43XXENCC
Fixing mounting recessed
Ø43mm H34mm

or

ACSFIPATER60XXENCAC
Fixing mounting recessed
Ø60mm H34mm

or

ACSFIPATER50XXAPPC
Fixing mounting ceiling
Ø50mm H30mm

or

ACSFIPA1704030XXAP1C
Fixing mounting ceiling
(driver in)
x1 spot : 170x40x30mm

or

ACSFIPA1704030WHAP2C
Fixing mounting ceiling
(driver in)
x2 spots : 170x40x30mm

ORDER REFERENCE (RCA TRIM NOMENCLATURE)

SD012-ARCA-BK-27
Spot D12 - RCA - Black(BK) - 2700K(27).

+

ACSDRCABKAPPC
Mounting RCA trim - Black(BK)
(Ø50mm)

=

ORDER REFERENCE (RCA TRIMLESS NOMENCLATURE)

SD012-ARCA-BK-27
Spot D12 - RCA - Black(BK) - 2700K(27).

+

ACSDRCAENCC
Mounting RCA trimless

=

Spot D12

ACCESSORIES

REF : SD012

SPOT

EN

↓ RCA ACCESSORIES

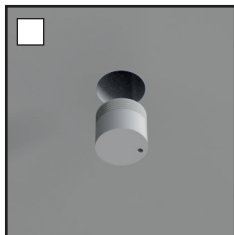

ACSDRCABOUCHONXXC
Finishing cap for RCA trim &
trimless mounting

↓ POWER SUPPLY CONNECTORS

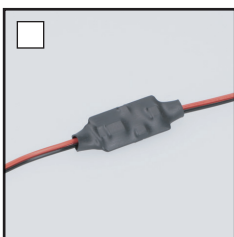

ACSD012COCIRCPXX500
Piccolo circuit with sheath
heat-shrinkable

↓ OPTICAL ACCESSORIES

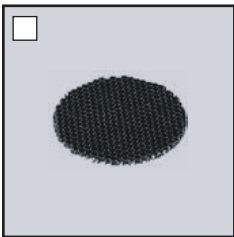

ACSD008OPNIDABBKD37C
Honeycomb Ø40mm

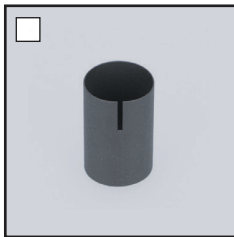

ACSD012SNOOTBKL10C
Snoot spot D12 +10mm